

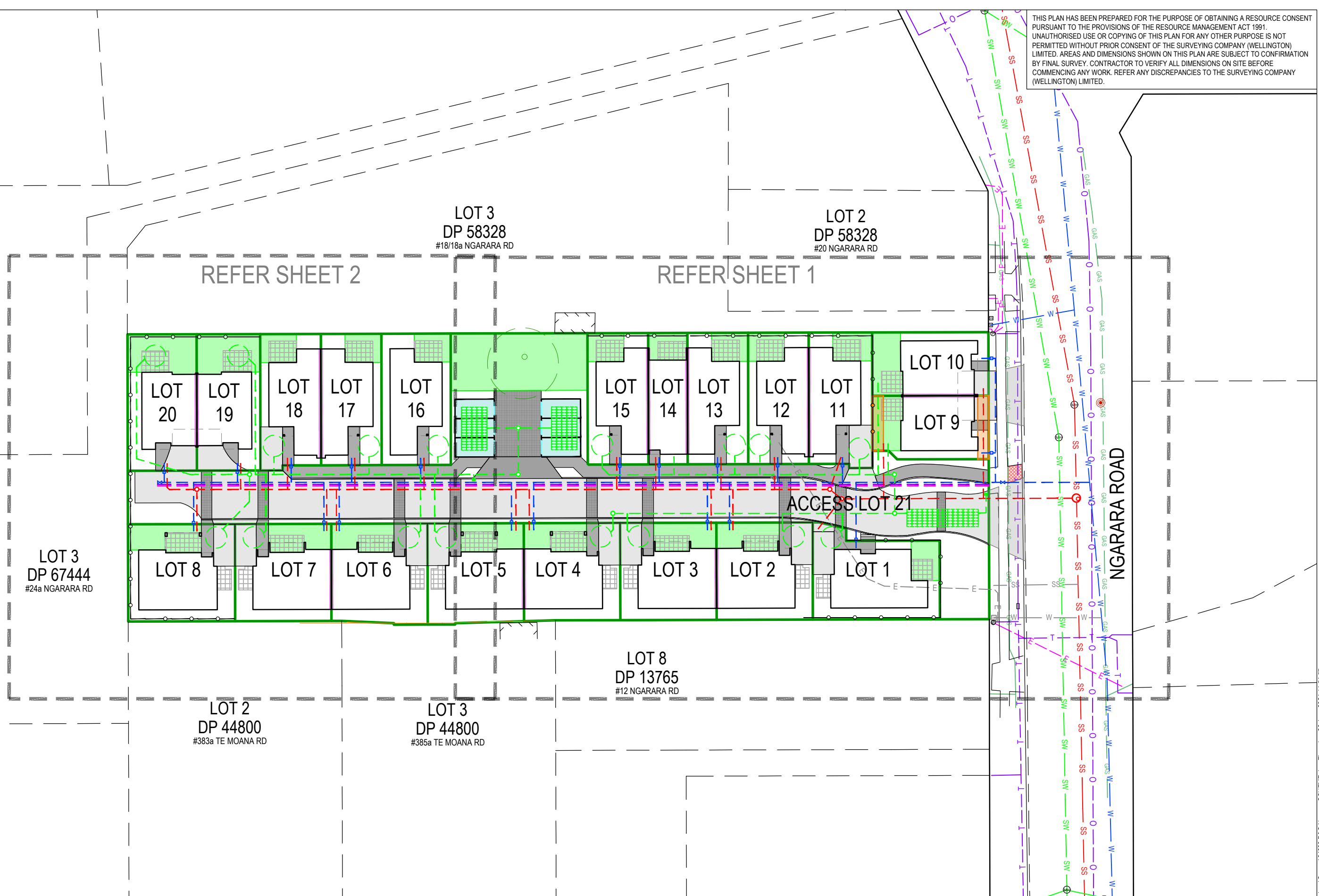

THIS PLAN HAS BEEN PREPARED FOR THE PURPOSE OF OBTAINING A RESOURCE CONSENT PURSUANT TO THE PROVISIONS OF THE RESOURCE MANAGEMENT ACT 1991. UNAUTHORISED USE OR COPYING OF THIS PLAN FOR ANY OTHER PURPOSE IS NOT PERMITTED WITHOUT PRIOR CONSENT OF THE SURVEYING COMPANY (WELLINGTON) LIMITED. AREAS AND DIMENSIONS SHOWN ON THIS PLAN ARE SUBJECT TO CONFIRMATION BY FINAL SURVEY. CONTRACTOR TO VERIFY ALL DIMENSIONS ON SITE BEFORE COMMENCING ANY WORK. REFER ANY DISCREPANCIES TO THE SURVEYING COMPANY (WELLINGTON) LIMITED.



THE SURVEYING COMPANY
YOUR LAND DEVELOPMENT CONSULTANTS

0800 TO SURVEY (0800 86 78 78) e-mail: projects@subdivision.net.nz
Cnr. King & Main Streets, PO Box 40083, Upper Hutt
ph: 04 527 9028

LOTS 1 TO 21 BEING A SUBDIVISION OF LOT 1 DP 44800
14-16 NGARARA ROAD, WAIKANAE
Prepared for P&C Ngarara Ltd

SCALE:	1:500 @ A3
CHECKED:	KC 29 MAY 2024
FIELDWORK:	TR 10 OCT 2023
DRAWN:	JWM 20 JUN 2024

JOB/DRAWING NUMBER	34898
OVERVIEW	

S:\Live Projects\34898 P&C Ngarara Drawings\Current\34898 P&C Ngarara SCHEME.dwg Thursday, 20 June 2024 11:54:57 am